

230<sub>VAC</sub>

# BULL17 OMI

## INDUSTRIAL USE

control unit with built-in inverter and virtual encoder  
control unit with mechanical ventilation  
oil lubricated reductions  
personalised release key

**up to 1700 kg**



## CONTROL UNITS:

**BULL17 OMI** ——— CP.BULL OMI

**BULL17 OMI.S** ——— CP.BULL OMI



## 230 Vac

- Single phase 230 VAC geared motor for intensive use with oil lubricated reductions
- The control unit, located on the top of the motor, facilitates wiring operations
- Oil lubrication guarantees maximum duration of the reducer. The type of oil is very effective and guarantees excellent performance even at low temperatures
- Reduced mechanical wear of components
- The virtual encoder allows proper management of the slowing-down phases, movement tracking (STC system), and torque management in relation to the position of the gate, which guarantees maximum safety
- Adjustable speed from 10 to 24 m/min according to gate weight
- Safety sensor that stops the motor power supply during release operations
- Receiver ONE2.WI is supplied
- Version with magnetic limit switches available (BULL17 OMI.S)
- Steel anti-vandal protective cover (optional)

Foundation plate with anchor bolts included.  
Motor and floor fixing distance 269x106 mm, no. 4 Ø 12 mm.

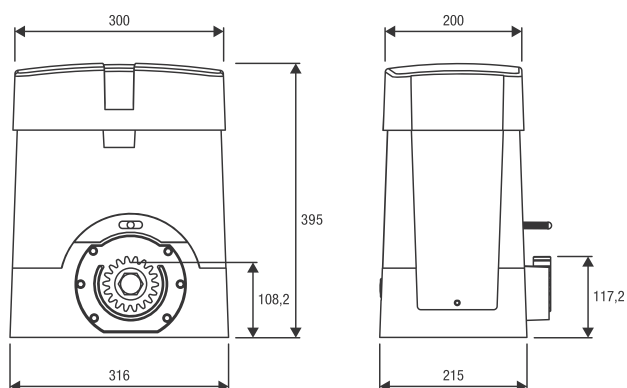

| Weight (kg) | Speed (m/min) |
|-------------|---------------|
| 1,700       | 17            |
| 1,000       | 20            |
| 500         | 24            |

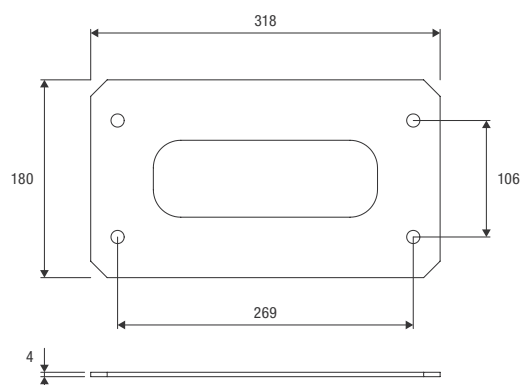

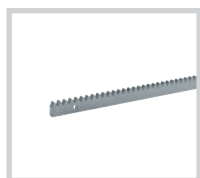
**RI.M4F**

M4 rack, to weld or attach with screws, 30x12x1000 mm slotted and galvanised. Supplied with M6 screws and threaded spacers.  
**Package of 4 pcs.**

**RI.M4F2**

M4 rack, to weld or attach with screws, 30x12x2000 mm slotted and galvanised. Supplied with M6 screws and threaded spacers.  
**Package of 1 pc.**

**RI.M4Z**

M4 galvanised rack to weld 22x22x2000 mm.  
**Package of 1 pc.**

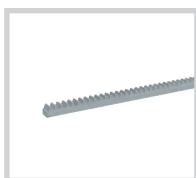
**RI.M4ZF**

Galvanised slotted M4 rack 22x22x2010 mm for fastening to the side with the teeth. Supplied with M6 screws.  
**Package of 1 pc.**

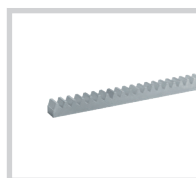
**RI.M6Z**

M6 galvanised rack to weld 30x30x2000 mm. Requires pinion RI.P6.  
**Package of 1 pc.**

**RI.P6**

M6 gear, it needs the rack RI.M6Z.

**BULL.PI**

Raised foundation plate. Height 32 mm. Floor fixing distance 280x170 mm, no. 4 Ø 11 mm. External dimensions 335x220 mm.

**BULL.CA**

Anti-vandal casing. Only for models with spring-loaded limit switches.

**RF.SUN**

Battery-operated device recharged by means of a photovoltaic panel applied on a mobile edge.

**RF**

Device with a non rechargeable battery, with guaranteed duration 2 years.

**SC.RF**

Device powered at 12/24 Vdc with self-test function and 2 outputs for connection to the electronic control units.

**AUTOMATISMI BENINCÀ SpA** • Via del Capitello, 45 • 36066 Sandrigo (VI) ITALY • T +39 0444 751030 • sales@beninca.com

| TECHNICAL DATA          | BULL17 OMI*       | BULL17 OMI.S*     |
|-------------------------|-------------------|-------------------|
| Power supply            | 230 Vac (50-60Hz) | 230 Vac (50-60Hz) |
| Motor supply            | 230 Vac           | 230 Vac           |
| Max absorbed current    | 7 A               | 7 A               |
| Max Thrust              | 1880 N            | 1880 N            |
| Max opening speed       | 24 m/min          | 24 m/min          |
| Duty cycle              | 60%**             | 60%**             |
| Protection level        | IP44              | IP44              |
| Magnetic limit switches | NO                | YES               |
| Operating temperature   | -20°C /+50°C      | -20°C /+50°C      |
| Lubrication             | OIL               | OIL               |
| Max gate weight         | 1700 kg           | 1700 kg           |
| Driving gear for rack   | M4 Z18            | M4 Z18            |
| Weight                  | 21.6 kg           | 21.6 kg           |
| Items no. per pallet    | 20                | 20                |

\* Available in 115 VAC version | \*\* In extreme operating conditions (environment T 50°C, speed 24 m/min, gate weight 500 kg) the cycle falls to 40%